

Trumy Diaphragm Couplings D2M series

D2M BENEFITS

- Very low overhung mass
- Very small bending moment
- Double diaphragm flexible coupling
- Allows angular misalignment up to $2/3^\circ$
- High strength stainless steel diaphragms
- Shims supplied to adjust the axial mounting gap
- Suitable for high and super-high speed applications

Intertech B.V.
Gildenveld 19
3892 DC Zeewolde
The Netherlands

T: +31(0)36 522 5885
E: info@intertech.nl
W: www.intertech.nl

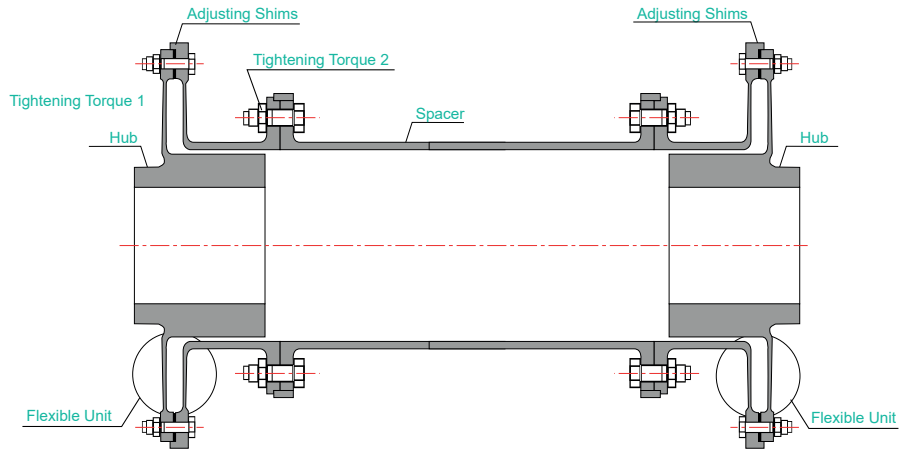

D2M SERIES COUPLING TECHNICAL DATA

Coupling type	Torque rating (kNm)			Max. speed (rpm)	Tightening torque 1/2 (Nm)	Total weight (Kg)	Centre of gravity (mm)	Torsional stiffness (MNm/Rad)	Moment of inertia (Kgm ²)	Angular misalignment		Axial displacement	
	Continuous	Peak	Momentary							Max. degree	Restoring moment (KNm/rad)	Max. ±mm	Axial force (N)
D2M315	2	2.66	3.54	33000	8/8	7	15.1	0.092	0.013	2/3	0.69	2.8	694
D2M317	4	5.32	7.07	28000	8/15	10	17.3	0.160	0.024		1.28	3.4	1102
D2M322	9	12	16	22000	15/25	20	21.4	0.426	0.084		2.79	4.6	1878
D2M327	18	23.9	31.8	18000	15/45	34	27.1	0.917	0.222		9.95	5.4	5821
D2M332	31.5	41.9	55.7	16000	15/100	54	33.5	1.666	0.494		10.89	7.0	4968
D2M337	45	59.8	79.6	14000	25/100	78	41.8	2.533	0.886		14.22	7.6	5438
D2M342	71	94.4	126	12000	25/150	112	46.4	3.892	1.707		21.84	9.0	7622
D2M347	100	133	177	11000	45/150	149	55.2	5.576	2.754		34.21	10.0	10600
D2M356	180	239	318	9000	45/180	263	72.6	10.730	6.265		56.44	12.2	14710
D2M415	2.5	3.33	4.42	33000	8/8	7	15.1	0.099	0.013	1/2	1.25	2.4	1054
D2M417	5.7	6.65	8.84	28000	8/15	10	17.3	0.170	0.024		2.48	3.0	1907
D2M422	11.2	14.9	19.8	22000	15/25	20	21.4	0.456	0.084		4.91	4.0	2894
D2M427	22.4	29.8	39.6	18000	15/45	34	27.1	0.887	0.222		12.61	4.8	5909
D2M432	40	53.2	70.7	16000	15/100	54	33.5	1.802	0.494		18.59	5.8	7261
D2M437	56	74.5	99.1	14000	25/100	78	41.8	2.754	0.886		25.57	6.6	8520
D2M442	90	120	159	12000	25/150	112	46.4	4.291	1.707		41.35	7.4	11760
D2M447	125	166	221	11000	45/150	149	55.2	6.137	2.754		58.69	8.4	15350
D2M456	224	299	396	9000	45/180	263	72.6	11.859	6.265		105.05	10.4	23260

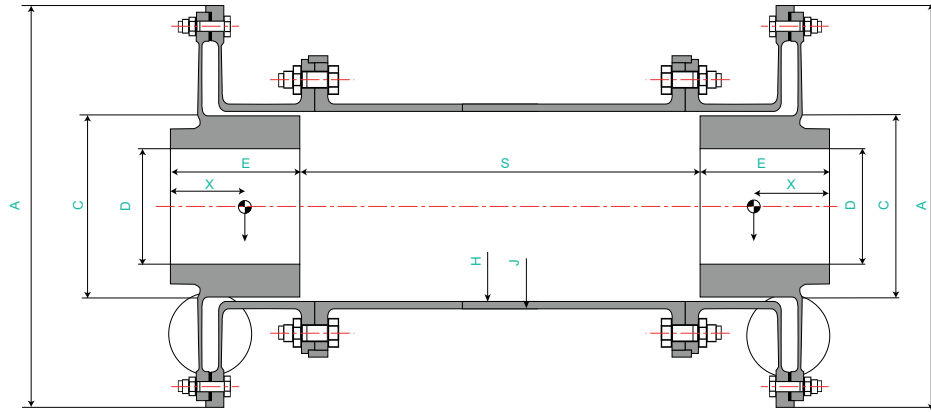

D2M SERIES COUPLING DIMENSIONS (mm)

Type	A	C max	D max	E	H	J	S	
							Std	Min
D2M315	155	70	45	50	73	79	460	50
D2M317	181	84	55	60	87	93	460	50
D2M322	233	108	70	80	112	121	460	70
D2M327	280	137	90	100	141	150	460	95
D2M332	332	162	105	115	167	180	460	100
D2M337	376	191	125	140	196	210	460	120
D2M342	433	214	140	160	219	236	460	120
D2M347	481	237	155	180	243	262	460	130
D2M356	571	290	190	220	296	319	460	150

D2M415	155	70	45	50	73	79	460	50
D2M417	181	84	55	60	87	93	460	50
D2M422	233	108	70	80	112	121	460	70
D2M427	280	137	90	100	141	150	460	95
D2M432	332	162	105	115	167	180	460	100
D2M437	376	191	125	140	196	210	460	120
D2M442	433	214	140	160	219	236	460	120
D2M447	481	237	155	180	243	262	460	130
D2M456	571	290	190	220	296	319	460	150

CUSTOMIZED DESIGN TO MEET SPECIFIC REQUIREMENTS

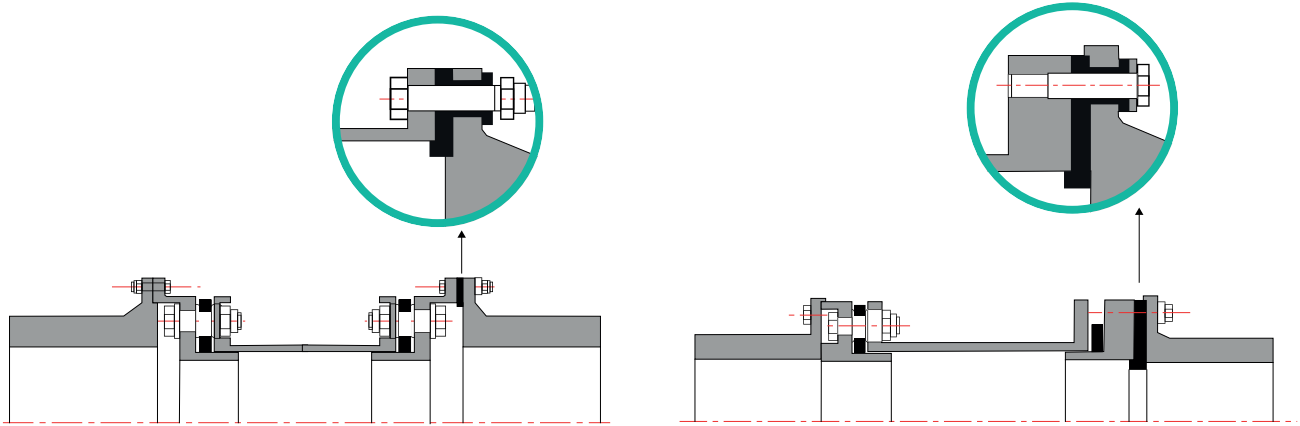

Electrically insulated

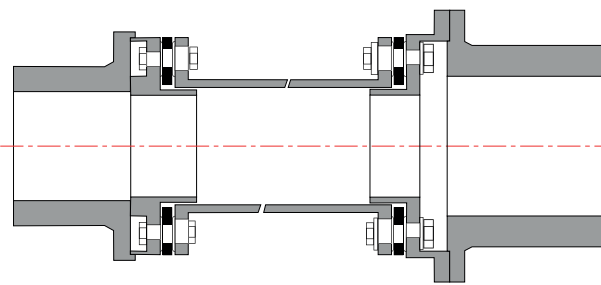

Limited end float by overload collars 2-3 mm

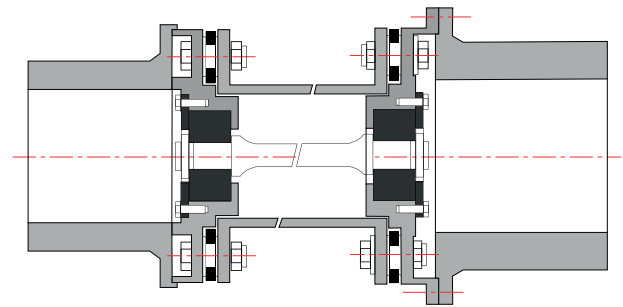

Limited end float by bone shaft 0 mm

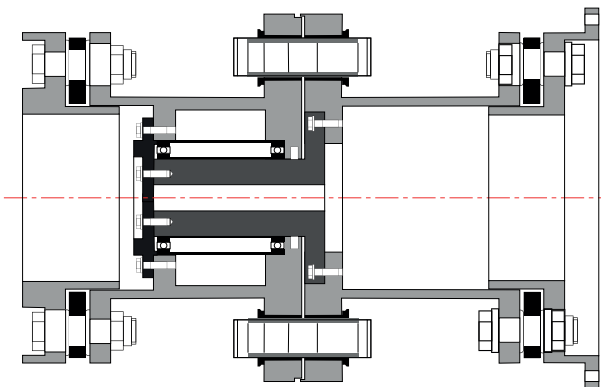

Design of overload protection

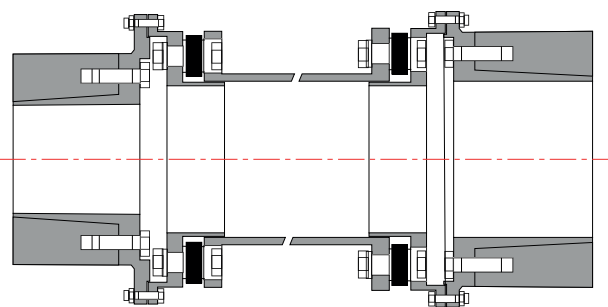

Hub design with shrink connection for easy fit

Intertech B.V.
Gildenveld 19
3892 DC Zeewolde
The Netherlands

T: +31(0)36 522 5885
E: info@intertech.nl
W: www.intertech.nl